

DC

INDUSTRIAL SPRAY NOZZLES - HOLLOW CONE

SPRAY CHARACTERISTICS

- *Hollow cone spray pattern with relatively large droplets at lower pressures.*
- *As pressure increases, the atomization becomes finer.*

CONSTRUCTION AND MATERIALS

- *Made up of five parts and available in these materials:*
- *Body - Brass and 316 Stainless Steel.*
- *Flanged Strainer - Brass, 316 Stainless Steel.*
- *Core - Nylon only (5 different sizes).*
- *Disc - 302 Stainless Steel (12 different sizes).*
- *Cap - Brass and 316 Stainless Steel.*
- *Body thread sizes are Male BSPT and Female BSPP.*

ORDER EXAMPLE

1/4" DCF (Female) 7-25 Brass.

1/8" DCM (Male) 6-23 Stainless Steel.

No. 8 Disc, No. 45 Core (can be ordered separately).

Maximum Recommended Pressure: 35 Bar.G.



CAPACITY CHARTS

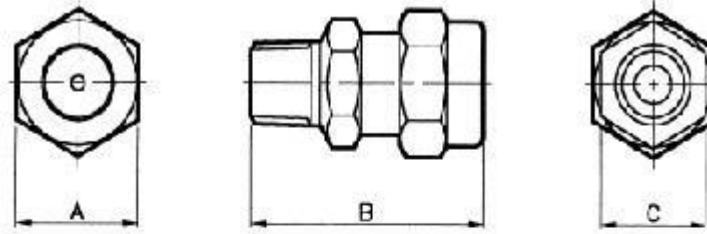

DCM (MALE) ASSEMBLY

DIMENSIONS AND WEIGHTS

<i>Assembly Type</i>	<i>Dimensions (mm)</i>			<i>Weight (g)</i>
	<i>A Hex</i>	<i>B</i>	<i>C Hex</i>	
1/8 DCF	20,8	40,0	18,0	65
1/8 DCM	20,8	38,4	18,0	55
1/4 DCF	20,8	40,0	18,0	64
1/4 DCM	20,8	40,0	18,0	55

CAPACITY CHART

NOZZLE NUMBER		FLOW RATE IN LITRES/MIN AT Bar.G.						SPRAY ANGLE (°)
TYPE	DISC-CORE	2,8	5	7	10	15	25	AT 2,8 Bar.G.
DC	2-13	0,31	0,41	0,48	0,58	0,71	0,91	70
DC	3-13	0,34	0,46	0,54	0,65	0,79	1,03	70
DC	2-23	0,38	0,51	0,60	0,72	0,88	1,14	65
DC	3-23	0,46	0,61	0,72	0,86	1,06	1,37	70
DC	4-13	0,46	0,61	0,72	0,86	1,06	1,37	80
DC	2-25	0,61	0,82	0,96	1,15	1,41	1,82	50
DC	5-23	0,69	0,92	1,09	1,30	1,59	2,05	90
DC	3-25	0,72	0,97	1,15	1,37	1,68	2,17	65
DC	6-23	0,80	1,07	1,27	1,51	1,85	2,39	95
DC	3-45	0,88	1,17	1,39	1,66	2,03	2,62	60
DC	4-25	1,11	1,48	1,75	2,09	2,56	3,30	75
DC	3-46	1,22	1,63	1,93	2,30	2,82	3,65	20
DC	5-25	1,33	1,78	2,11	2,52	3,09	3,99	80
DC	6-25	1,68	2,24	2,65	3,17	3,88	5,01	85
DC	5-45	1,72	2,29	2,71	3,24	3,97	5,13	75
DC	7-25	1,98	2,65	3,14	3,75	4,59	5,93	90
DC	6-45	2,21	2,96	3,50	4,18	5,12	6,61	80
DC	8-25	2,33	3,11	3,68	4,40	5,38	6,95	95
DC	7-45	2,59	3,47	4,10	4,90	6,00	7,75	85
DC	5-46	2,94	3,92	4,64	5,55	6,80	8,77	40
DC	8-45	3,05	4,28	5,07	6,05	7,41	9,57	90
DC	12-25	3,55	4,74	5,61	6,70	8,21	10,6	110
DC	14-25	3,81	5,10	6,03	7,21	8,83	11,4	110
DC	6-46	4,20	5,61	6,63	7,93	9,71	12,5	50
DC	10-45	4,20	5,61	6,63	7,93	9,71	12,5	90
DC	7-46	5,34	7,13	8,44	10,1	12,4	16,0	55
DC	12-45	5,34	7,13	8,44	10,1	12,4	16,0	100
DC	14-45	5,72	7,64	9,04	10,8	13,2	17,1	105
DC	8-46	6,86	9,17	10,9	13,0	15,9	20,5	60
DC	10-46	9,53	12,7	15,1	18,0	22,1	28,5	65