

LQ

## INDUSTRIAL SPRAY NOZZLES - FLAT SPRAY

### SPRAY CHARACTERISTICS

- Produces a uniform flat fan shaped pattern.
- Requires minimal overlapping to produce an even distribution when used in multiple nozzle system.
- High pressure body design with replaceable insert.
- A wide range of flow rates and spray angles.
- 0° nozzle sizes available on request.
- Orifice offset -5° to axis of dovetail.

### CONSTRUCTION AND MATERIALS

- Dovetail connection Nozzle/body for positive alignment.
- 3 piece construction. Body, tip and cap.
- The tip is dovetailed for self alignment.
- The orifice insert is manufactured in Tungsten Carbide for maximum wear resistance at higher pressures.
- The high pressure body, cap and orifice housing are manufactured in Stainless Steel as standard.
- Standard Male and Female thread bodies are available and also an optional welding body.

### ORDER EXAMPLE

LQ 4 - 65° = Tip Only.

1/4" LQM (Male) 8 - 40° = Complete Assembly.

LQW 2 - 65° = Welding Assembly.

Maximum Recommended Pressure: 350 Bar.G.}



## CAPACITY CHARTS

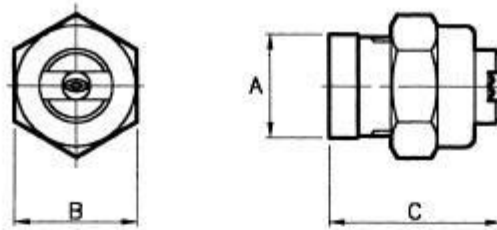

LQ (WELDING) ASSEMBLY

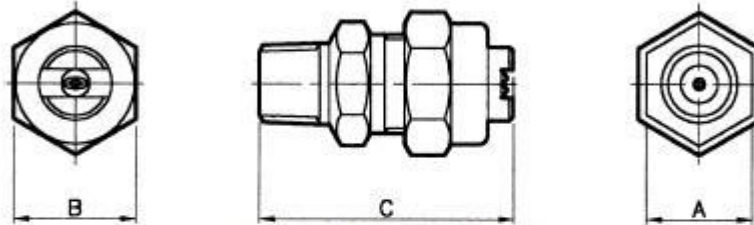

LQ (MALE) ASSEMBLY

### DIMENSIONS AND WEIGHTS

Thread Size	Assembly Type	Dimensions (mm)			Weight (g)
		A Hex	B Hex	C	
1/8	LQF	18,0	20,8	43,0	65
1/4	LQF	18,0	20,8	43,0	64
1/4	LQM	18,0	20,8	43,0	57
3/8	LQF	20,8	20,8	43,0	65
3/8	LQM	18,0	20,8	43,0	59
-	LQW	17,5 dia.	20,8	29,2	46

## CAPACITY CHART

NOZZLE NUMBER	Equiv. orifice size (mm)	FLOW RATE IN LITRES/MIN AT Bar.G.								SPRAY ANGLES (°) @ 70 Bar.G.					
		35	50	70	100	140	210	280	350	25	40	50	65	80	95
LQ 0,5	0,45	0,68	0,81	0,94	1,14	1,36	1,66	1,92	2,15						
LQ 0,6	0,51	0,75	0,89	1,06	1,26	1,51	1,84	2,13	2,38						
LQ 0,7	0,53	0,90	1,07	1,25	1,52	1,78	2,18	2,51	2,81						
LQ 0,8	0,61	1,14	1,36	1,59	1,92	2,27	2,78	3,21	3,59						
LQ 1,0	0,66	1,32	1,57	1,89	2,23	2,63	3,22	3,71	4,15						
LQ 1,25	0,74	1,70	2,03	2,38	2,87	3,39	4,15	4,79	5,36						
LQ 1,5	0,79	2,00	2,39	2,83	3,38	3,97	4,86	5,61	6,27						
LQ 2,0	0,91	2,68	3,20	3,78	4,53	5,29	6,47	7,48	8,36						
LQ 2,5	1,04	3,33	3,98	4,54	5,62	6,62	8,10	9,36	10,4						
LQ 3,0	1,09	4,16	4,97	5,67	7,03	7,94	9,72	11,2	12,5						
LQ 3,5	1,22	4,54	5,42	6,44	7,67	9,46	11,5	13,3	14,9						
LQ 4,0	1,32	5,30	6,33	7,57	8,95	10,5	12,8	14,8	16,6						
LQ 6,0	1,57	7,95	9,50	11,3	13,4	15,8	19,3	22,3	24,9						
LQ 8,0	1,83	10,6	12,6	15,1	17,9	21,1	25,8	36,4	33,3						
LQ 11,5	2,16	15,5	18,5	21,6	26,2	30,6	37,4	43,2	48,3						